

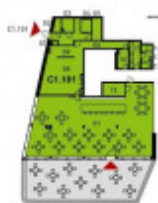

# Rent commercial business premises, 366 m<sup>2</sup> - Kobrova, Smíchov



ENCE | C1.101 | restaurace | 1. podlaží  
rozl. SATPO



- 01 - vstupní
- 02 - kuchyně
- 03 - jídelna
- 04 - sklad
- 05 - WC
- 06 - WC
- 07 - WC
- 08 - WC
- 09 - WC
- 10 - WC
- 11 - WC
- 12 - WC
- 13 - WC
- 14 - WC
- 15 - WC
- 16 - WC
- 17 - WC
- 18 - WC
- 19 - WC
- 20 - WC
- 21 - WC
- 22 - WC
- 23 - WC
- 24 - WC
- 25 - WC
- 26 - WC
- 27 - WC
- 28 - WC
- 29 - WC
- 30 - WC
- 31 - WC
- 32 - WC
- 33 - WC
- 34 - WC
- 35 - WC
- 36 - WC
- 37 - WC
- 38 - WC
- 39 - WC
- 40 - WC
- 41 - WC
- 42 - WC
- 43 - WC
- 44 - WC
- 45 - WC
- 46 - WC
- 47 - WC
- 48 - WC
- 49 - WC
- 50 - WC
- 51 - WC
- 52 - WC
- 53 - WC
- 54 - WC
- 55 - WC
- 56 - WC
- 57 - WC
- 58 - WC
- 59 - WC
- 60 - WC
- 61 - WC
- 62 - WC
- 63 - WC
- 64 - WC
- 65 - WC
- 66 - WC
- 67 - WC
- 68 - WC
- 69 - WC
- 70 - WC
- 71 - WC
- 72 - WC
- 73 - WC
- 74 - WC
- 75 - WC
- 76 - WC
- 77 - WC
- 78 - WC
- 79 - WC
- 80 - WC
- 81 - WC
- 82 - WC
- 83 - WC
- 84 - WC
- 85 - WC
- 86 - WC
- 87 - WC
- 88 - WC
- 89 - WC
- 90 - WC
- 91 - WC
- 92 - WC
- 93 - WC
- 94 - WC
- 95 - WC
- 96 - WC
- 97 - WC
- 98 - WC
- 99 - WC
- 100 - WC

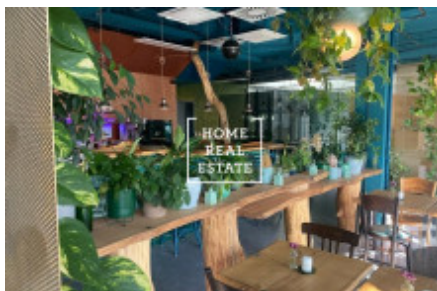

ID	<a href="#">36097</a>	Offer	Rental
Group	Business premises	Furnished	unfurnished
Location	Kobrova	Usable area	366 m <sup>2</sup>
Floor	0 - Floor	City	<a href="#">Prague</a>
District	<a href="#">Smíchov</a>	City district	<a href="#">Smíchov</a>
Status	Realized		